

Har1700 Series

FLEXIBLE CHAINS

FLEXIBLE CHAINS 1700

P=50.0mm, T=23.9mm

PIN:Stainless steel

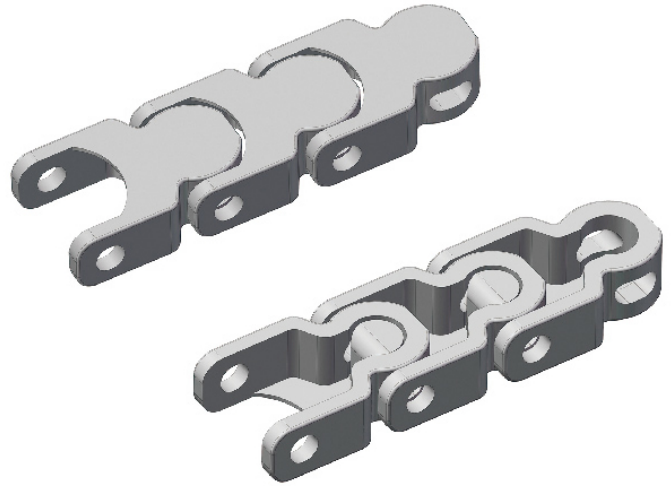

节距 Pitch	链板材质 Material	颜色 Color
50.0mm	POM	白色/White

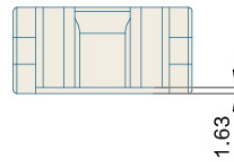
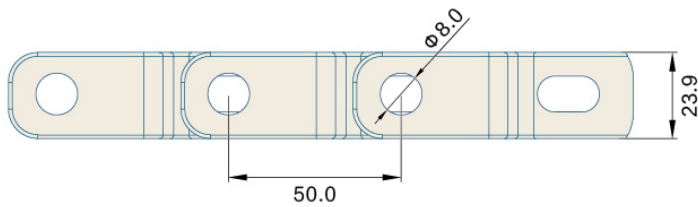
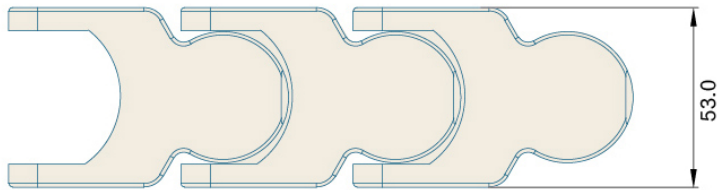

型号 Type No.	宽度 Width (mm)	节距 Pitch (mm)	重量 Weight (Kg/m)	转弯半径 Radius (mm)	负载 Working Capacity (N)
Har1700	53.0	50.0	1.4	250.0	4000

链轮 Sprocket	护栏 Guide	弯轨 Guide Rails	其余配件 Component
S34	R01-R42	G08	C01-C57