

Har882M Series Curve

TOP CHAINS

TOP CHAINS 882

P=38.1mm, T=19mm

PIN:Stainless steel

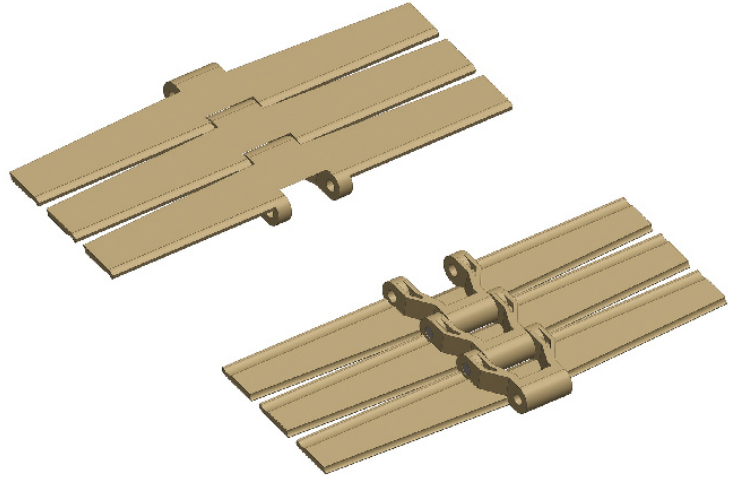

节距 Pitch	链板材质 Material	颜色 Color
38.1mm	POM	咖啡色/Brown

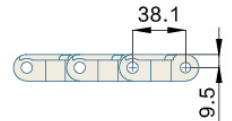
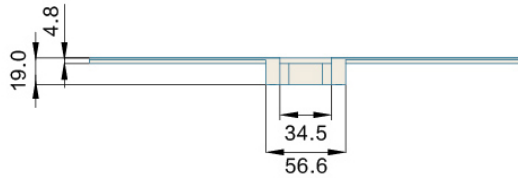
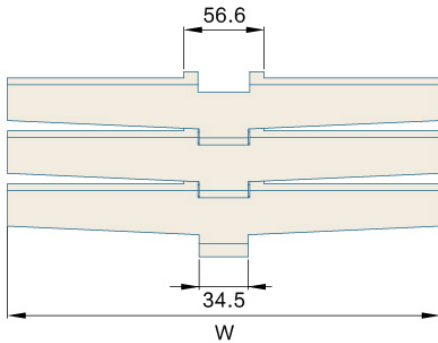

型号 Type No.	宽度 Width (mm)	节距 Pitch (mm)	重量 Weight (Kg/m)	转弯半径 Radius (mm)	负载 Working Capacity (N)
Har882M-K450	114.3	38.1	1.19	610mm	3830
Har882M-K600	152.4	38.1	1.78	610mm	3830
Har882M-K750	190.5	38.1	2.16	610mm	3830
Har882M-K1000	254.0	38.1	2.35	610mm	3830
Har882M-K1200	304.8	38.1	2.65	610mm	3830

链轮 Sprocket	护栏 Guide	弯轨 Guide Rails	其余配件 Component
S19-S20	R01-R42	—	C01-C57