

# Har2401 Flush Grid

## MODULAR BELT

MODULAR BELT 2401

P=25.4mm, T=11mm

OPEN AREA:35%

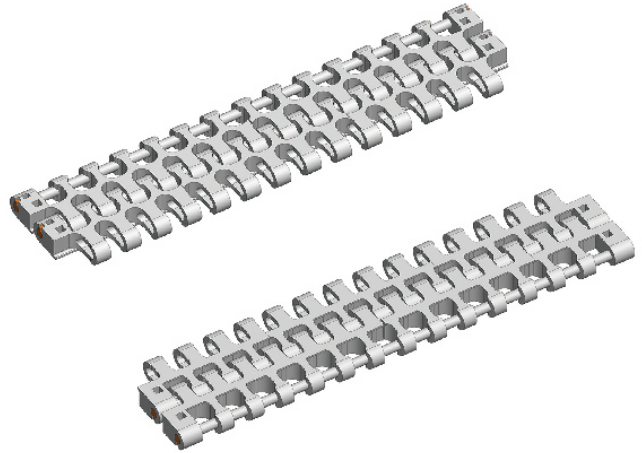

节距 Pitch	网链材质 Material	颜色 Color	转弯系数 Turn Radius
25.4mm	POM	白色/White 蓝色/Blue	2.5
	PP	白色/White	

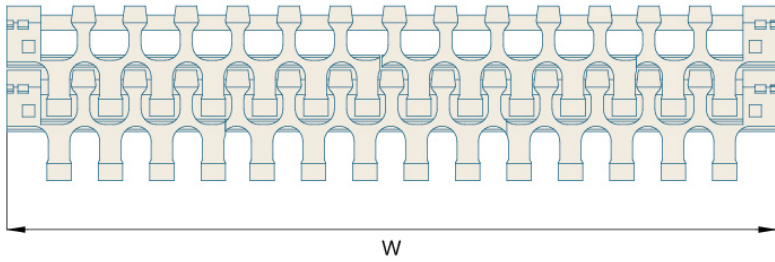

挡板高度 Cleat Height	—	材质 Material	重量 Weight(KG/SQ)	工作负荷 Working Capacity(N/M)
裙边高度 Side Apron Height	—	POM	7.3	26000
穿销材质 Pin Material	PP/NYLON/PBT	PP	5.0	19000

可选宽度 Available Width

塑料缩水率引致的正常误差：正负差距 ± 3(mm) The normal error caused by the shrinkage of plastic: ± 3(mm)

单片宽度 ( Bulk Pieces Width )			组合宽度 ( Assemble Width )
70mm	200mm	120mm	70+120+12*N
非标宽度 Nonstandard Width			非标定制前请和本公司联系 PLS Contact Hairise Confirm Width Before Booking

链轮 Sprocket	护栏 Guide	其余配件 Component
S45	R01-R42	C01-C57