

Har2546 Series Flush Grid

MODULAR BELT

MODULAR BELT 2546 Series

P=38.1mm, T=18mm

OPEN AREA:31%

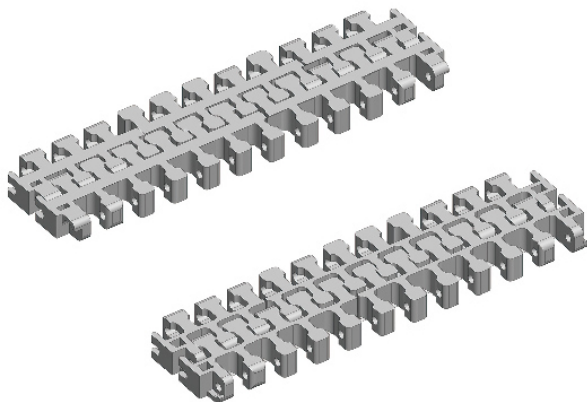

节距 Pitch	网链材质 Material	颜色 Color	转弯系数 Turn Radius
38.1mm	PP	白色/White	2.5

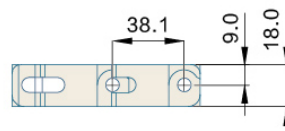
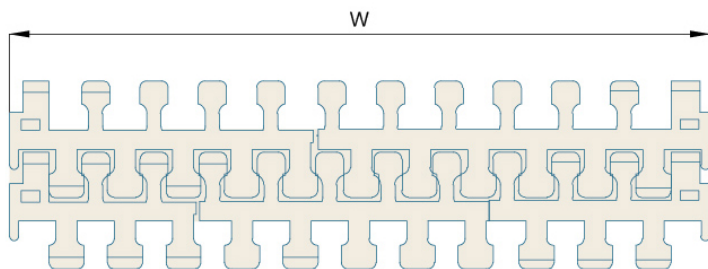

挡板高度 Cleat Height	—	材质 Material	重量 Weight(KG/SQ)	工作负荷 Working Capacity(N/M)
裙边高度 Side Apron Height	—	PP	8.0	23000
穿销材质 Pin Material	PP/NYLON/PBT DIAMETER:6.5mm	—	—	—

可选宽度 Available Width

塑料缩水率引致的正常误差: 正负差距 ± 3(mm) The normal error caused by the shrinkage of plastic: ± 3(mm)

单片宽度 (Bulk Pieces Width)	组合宽度 (Assemble Width)
130.7mm	—
非标宽度 Nonstandard Width	非标定制前请和本公司联系 PLS Contact Hairise Confirm Width Before Booking

链轮 Sprocket	护栏 Guide	其余配件 Component
—	R01-R42	C01-C57