

# Har2100 Series

## FLEXIBLE CHAINS

FLEXIBLE CHAINS 2100

P=34.8mm, T=24.6mm

PIN:Stainless steel

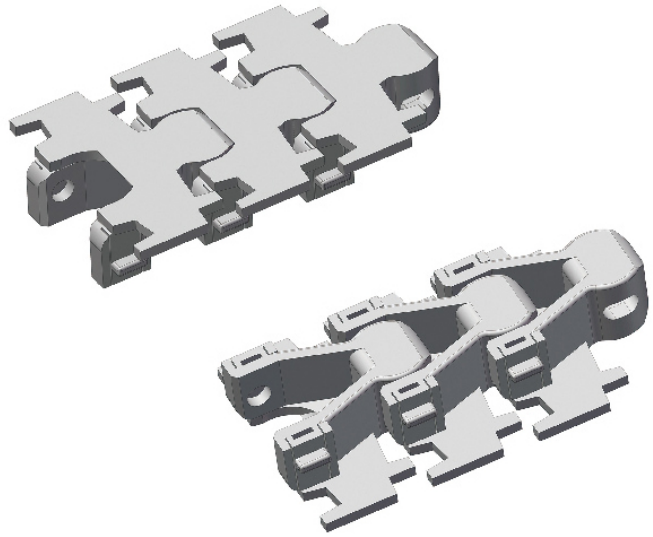

节距 Pitch	链板材质 Material	颜色 Color
34.8mm	POM	白色/White

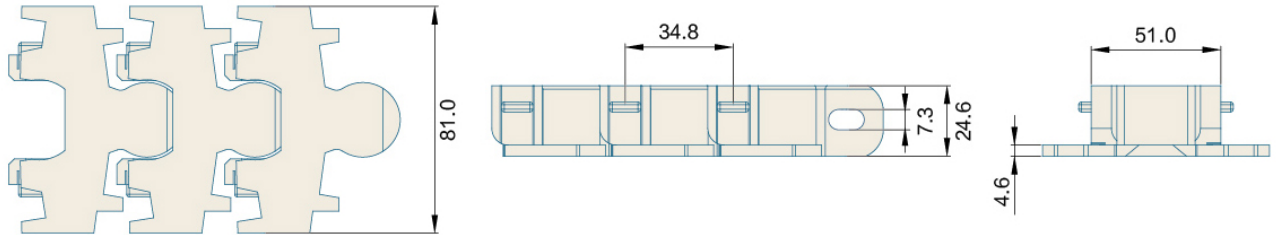

型号 Type No.	宽度 Width (mm)	节距 Pitch (mm)	重量 Weight (Kg/m)	转弯半径 Radius (mm)	负载 Working Capacity (N)
Har2100	81.0	34.8	1.35	150	2100

链轮 Sprocket	护栏 Guide	弯轨 Guide Rails	其余配件 Component
S45	R01-R42	—	C01-C57