

# Har1100 Series Flush Grid

## MODULAR BELT

MODULAR BELT 1100 Series

P=15.2mm, T=8.7mm

OPEN AREA:28%

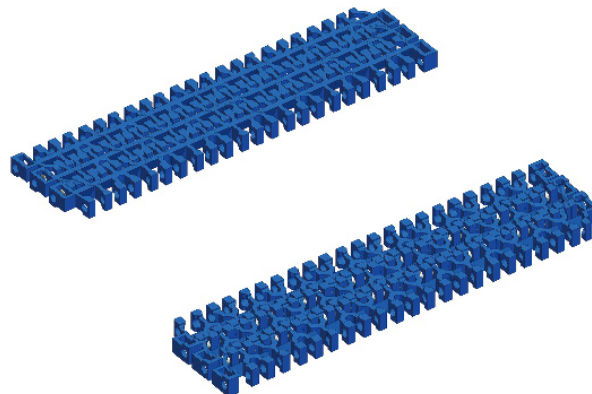

节距 Pitch	网链材质 Material	颜色 Color
15.2mm	POM	蓝色/Blue
15.2mm	PP	灰色/Gray

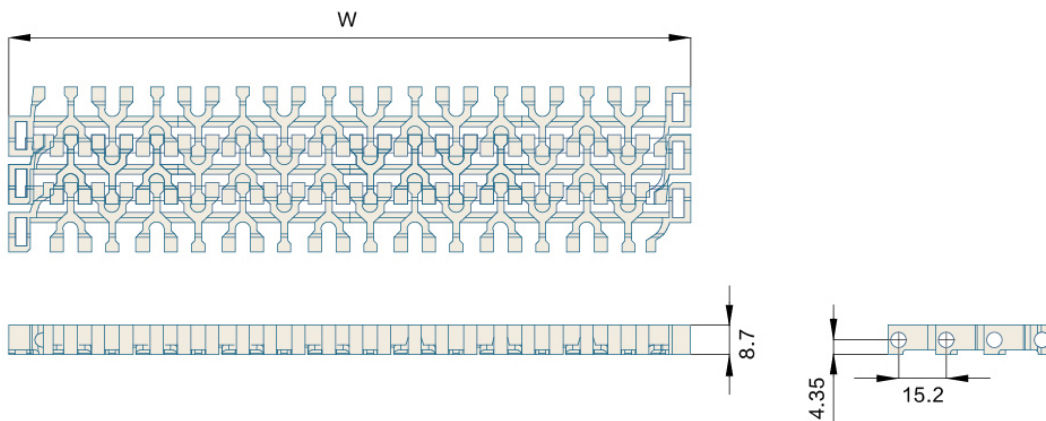

挡板高度 Cleat Height	5/50mm	材质 Material	重量 Weight(KG/SQ)	工作负荷 Working Capacity(N/M)
裙边高度 Side Apron Height	—	POM	5.80	14000
穿销材质 Pin Material	PP/NYLON/PBT DIAMETER:4.6mm	PP	3.95	9000

可选宽度 Available Width

塑料缩水率引致的正常误差: 正负差距±3(mm) The normal error caused by the shrinkage of plastic: ±3(mm)

单片宽度 ( Bulk Pieces Width )			组合宽度 ( Assemble Width )
50mm	152mm	100mm	50+100+50*N
非标宽度 Nonstandard Width			非标定制前请和本公司联系 PLS Contact Hairise Confirm Width Before Booking

链轮 Sprocket	护栏 Guide	其余配件 Component
S27-S28	R01-R42	C01-C57