

Har2275 Series Turning Type With Bearing

MODULAR BELT

MODULAR BELT 2275 Series

P=31.75mm, T=12.7mm

OPEN AREA:39%

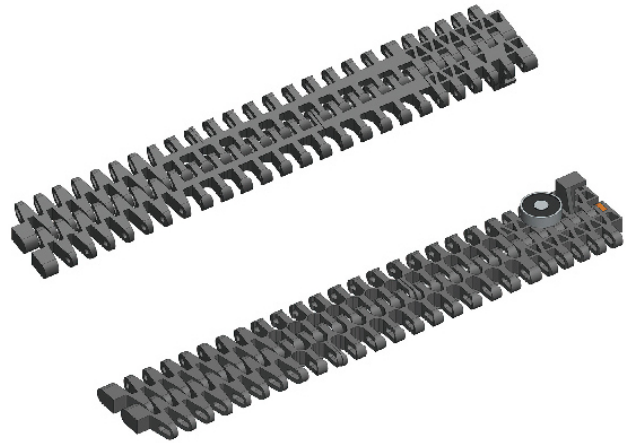

节距 Pitch	网链材质 Material	颜色 Color	转弯系数 Turn Radius
31.75mm	POM	棕色/Brown	1.8

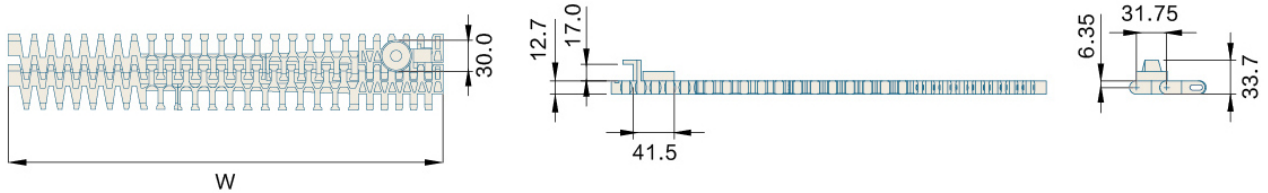

挡板高度 Cleat Height	—	材质 Material	重量 Weight(KG/SQ)	工作负荷 Working Capacity(N/M)
裙边高度 Side Apron Height	—	POM	8.0	25000
穿销材质 Pin Material	PP/NYLON/PBT DIAMETER: 5mm	PP	5.2	16000

可选宽度 Available Width

塑料缩水率引致的正常误差: 正负差距 ± 3(mm) The normal error caused by the shrinkage of plastic: ± 3(mm)

单片宽度 (Bulk Pieces Width)			组合宽度 (Assemble Width)
170mm	170mm	255mm	425mm+85mm*N
非标宽度 Nonstandard Width			非标定制前请和本公司联系 PLS Contact Hairise Confirm Width Before Booking

链轮 Sprocket	护栏 Guide	其余配件 Component
S40	R01-R42	C01-C57