

# Har5935 Series Flush Grid Dynamic Transition

## MODULAR BELT

MODULAR BELT 5935 Series

P=19.05mm, T=8.7mm

OPEN AREA:16%

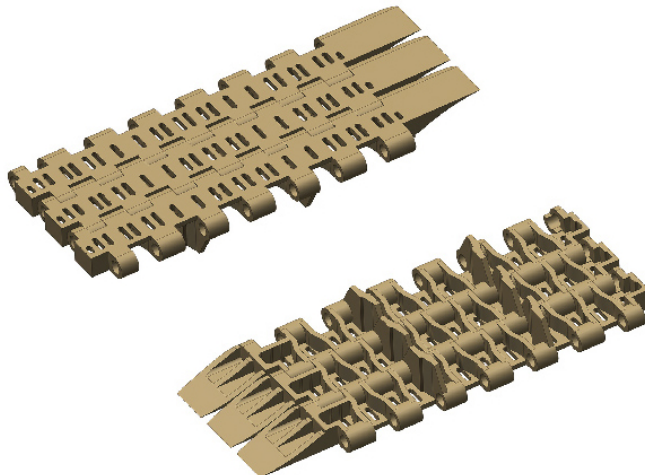

节距 Pitch	网链材质 Material	颜色 Color
19.05mm	POM	棕色/Brown

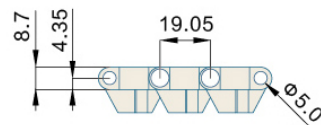
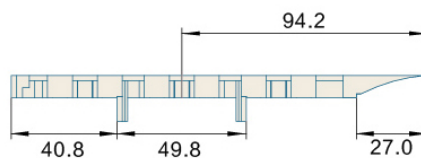
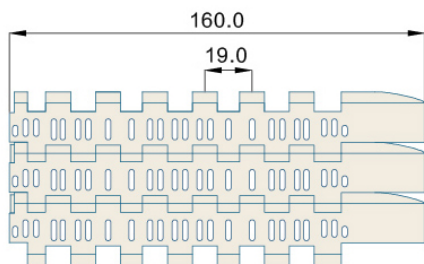

挡板高度 Cleat Height	—	材质 Material	重量 Weight(KG/M)	工作负荷 Working Capacity(N/M)
裙边高度 Side Apron Height	—	POM	1.04	2080
穿销材质 Pin Material	PP/NYLON/PBT DIAMETER:4.6mm	—	—	—

可选宽度 Available Width

塑料缩水率引致的正常误差: 正负差距  $\pm 3$ (mm) The normal error caused by the shrinkage of plastic:  $\pm 3$ (mm)

单片宽度 ( Bulk Pieces Width )	组合宽度 ( Assemble Width )
160mm	—
非标宽度 Nonstandard Width	非标定制前请和本公司联系 PLS Contact Hairise Confirm Width Before Booking

链轮 Sprocket	护栏 Guide	其余配件 Component
S51	R01-R42	C01-C57